

# MK - SPL

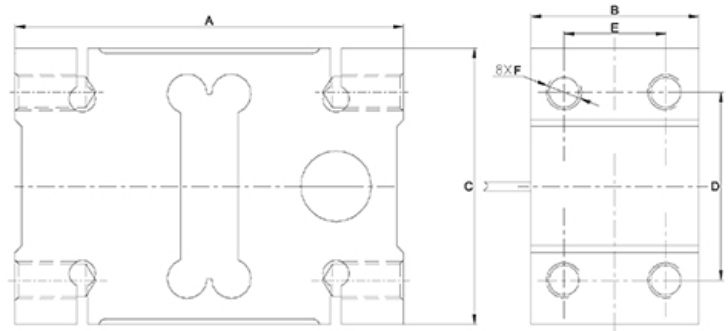

### FEATURE:

- High capacity versatile single point load cell
- Suitable for most simple weighing scale in industrial use
- Large platform application
- Typical applications often include bench scale, packaging machines, filling machines, industrial process control
- Use high quality anodize aluminium

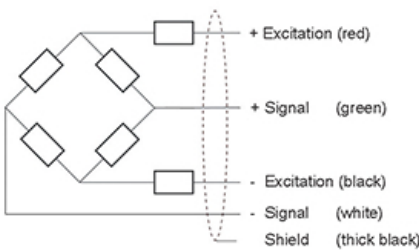

### SPECIFICATION

Rated Load (kg)	A	B	C	D	E	F
50-200	156	44	75	50	24	M12
300 - 500	146	60	95	70	36	M12
750 - 2000	176	76	125	95	46	M16

Rated capacities (Emax)	50,100,200,300,500,750kg,1t,2t	Temperature, compensated	-10°C~+40°C
Rated Output	2.0±0.2mV/V	Temperature, operating	-20°C~+50°C
Accuracy class	C3	Maximum safe overload	150%Emax
Creep error (30min)	±166ppm	Ultimate overload	300%Emax
Zero balance	±3%Emax	Excitation, recommended	10V DC
TC ZERO	±17.5ppm/°C	Excitation, maximum	15V DC
TC SPAN	+20°C~+40°C,±17.5ppm/°C	Protection class	IP65
	-10°C~+20°C,±11.67ppm/°C	Construction	Aluminium Anodized
Input resistance	404±15Ω	Cable	3m@ Φ 5mm
Output resistance	350±3Ω		
Insulation resistance	≥2000MΩ (50V DC)	Installation torque, recommended	35N-m
Max platform size	50-200kg 600x600mm, 300-500kg 600x800mm, 750-2000kg 1200x1200mm		